

IGA SERIES PHOTODIODE

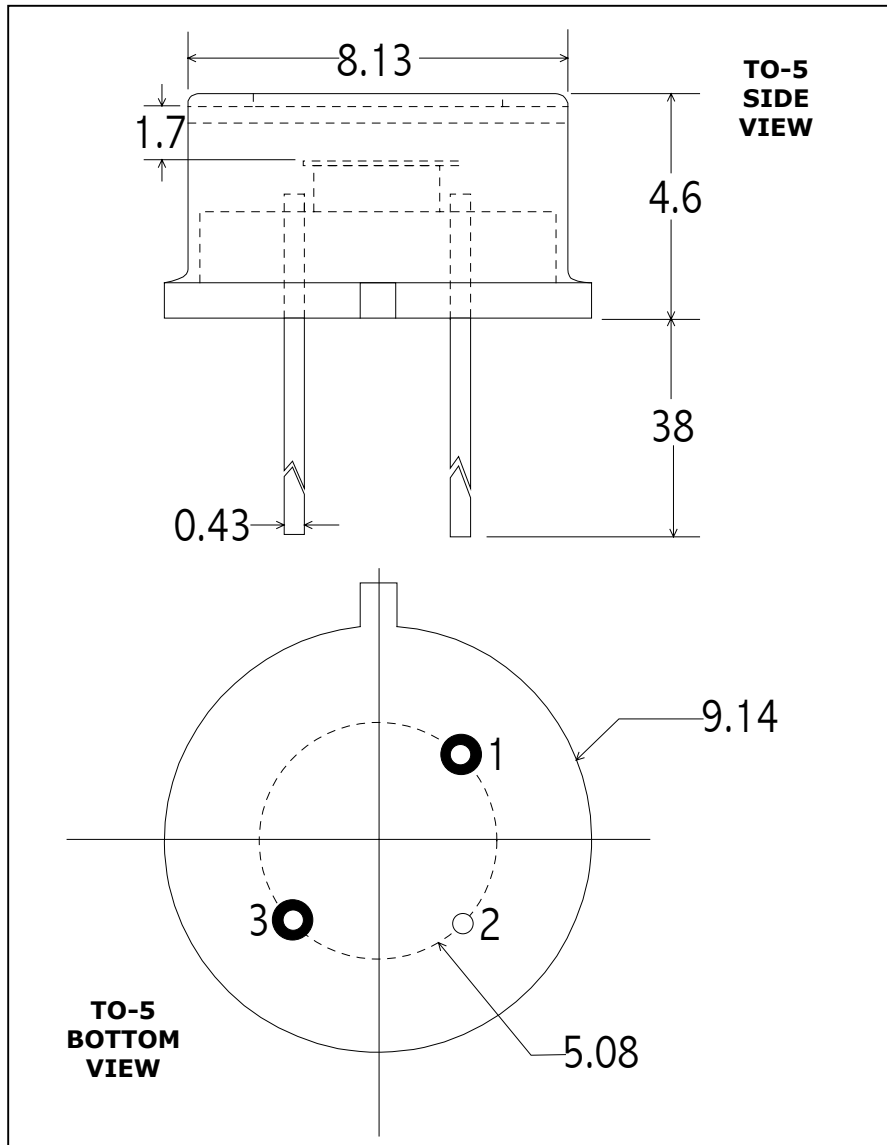

PIN OUT

- 1 = ANODE
- 2 = CASE
- 3 = CATHODE

Note:

Dimensions in millimeters

Application Note

ELECTRO OPTICAL SYSTEMS offers room temperature photodiode detectors. The units have state-of-the-art sensitivity and may be supported by accessories such as optical filters (longpass and bandpass), integral preamplifiers, and fiber optic connectors. These units find applications in industrial control systems, gas analyzers, thermal sensors, and general fiber optic test instrumentation.

SPECIFICATIONS

Part Number	IGA - 020	IGA - 030
Active Area	2.0 mm dia	3.0 mm dia
Operating Wavelength - μm	1.0 - 1.7	
Shunt Resistance (Ω)	$\geq 10\text{M}$	$\geq 5\text{M}$
Shunt Capacitance (pF), typ	400	1000
Responsivity (A/W) @ 1.3 μm	0.9	0.9
NEP ($\text{W}/\text{Hz}^{1/2}$), @ 1.3 μm , 100 Hz	$< 5 \times 10^{-14}$	$< 7 \times 10^{-14}$