

SILICON QUADRANT DETECTOR

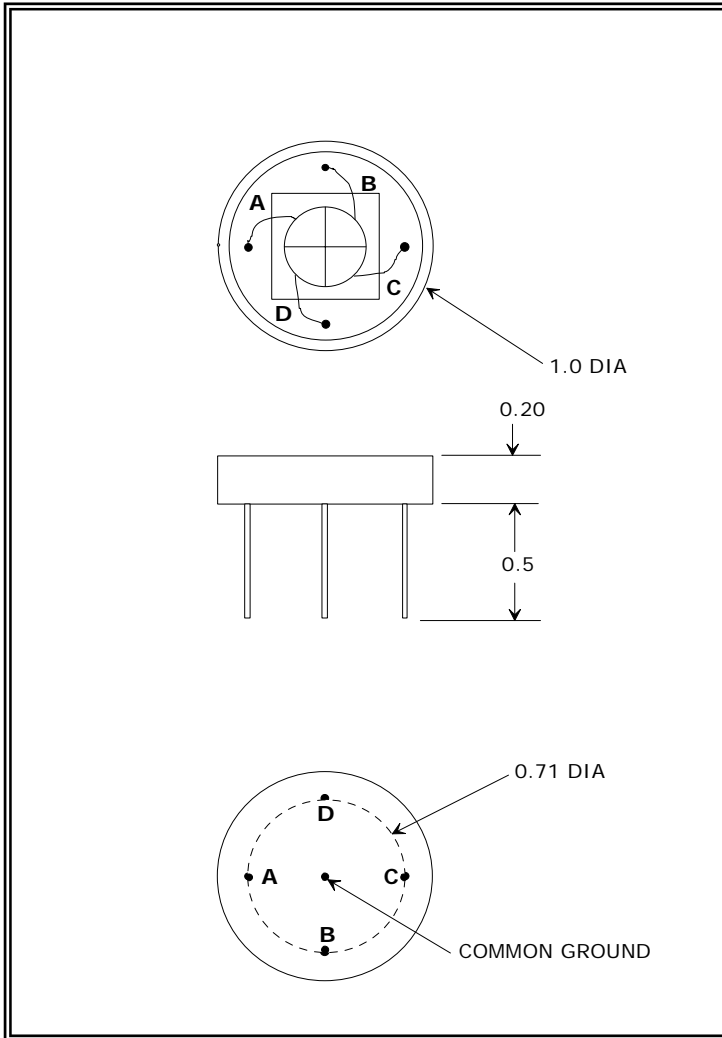

ELECTRO-OPTICAL SYSTEMS offers room temperature quadrant photodiode components in a variety of sizes and materials. The devices have state-of-the-art performance characteristics and are supported by optical and electronic accessories. They find applications in laser pointing and tracking, beam centering, nulling and position measurement.

SPECIFICATIONS @ 23° C

Part Number	S - 100 - QD
Detector Type	Silicon Photodiode
Active Diameter (mm), Overall	10 mm
Operating Wavelength (nm)	300 - 1100
Shunt Resistance - ohms (Each Quadrant)	> 100 M
Shunt Capacitance (pF) (Each Quadrant)	200 typ
Responsivity (A/W)	0.6 min @ 850 nm
Element Spacing	< 20 microns
Crosstalk	< 1%