

2 - COLOR PHOTODIODE

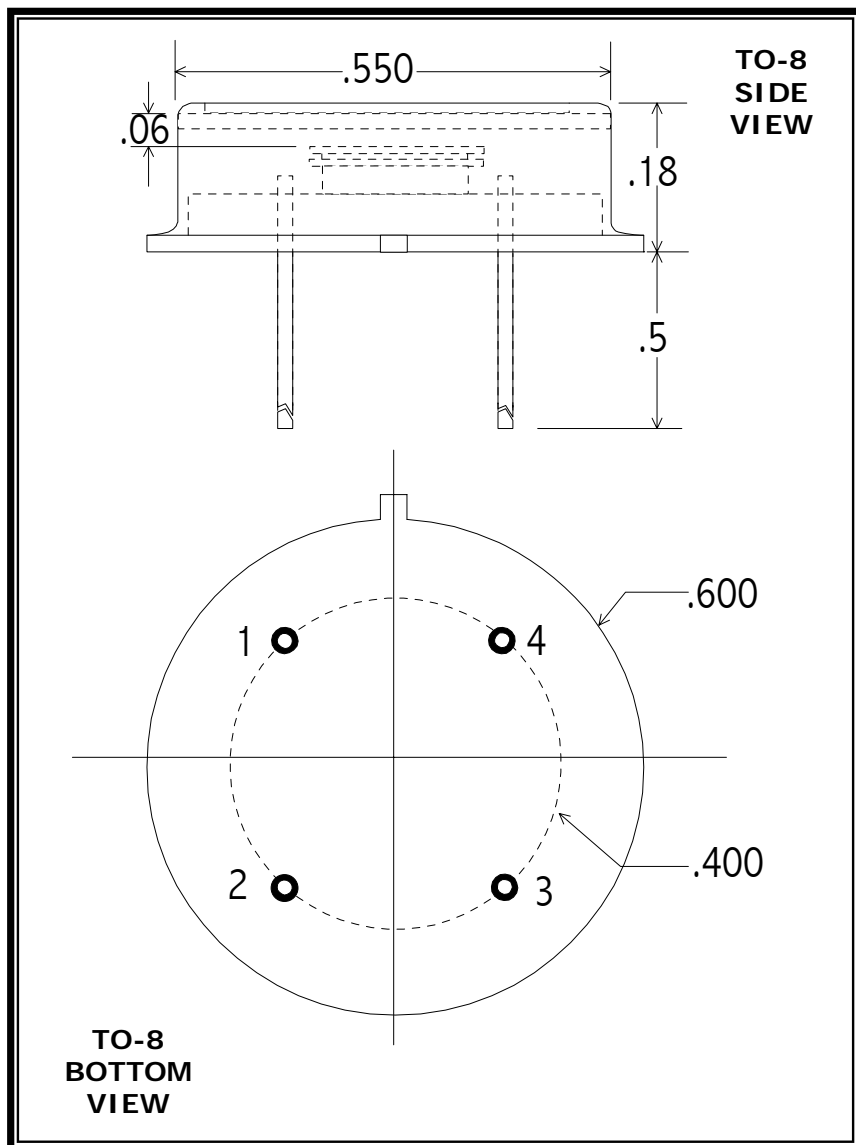

Part No: UVS/IGA-050/030

PIN OUT

- 1 = TOP CATHODE
- 2 = TOP ANODE
- 3 = BOTTOM ANODE
- 4 = BOTTOM CATHODE

Note:
Dimensions in inches

Application Note

ELECTRO OPTICAL SYSTEMS offers a variety of room temperature 2-color photodiode detectors. The units have state-of-the-art sensitivity and are supported by accessories such as optical filters, integral preamplifiers, and fiber optic connectors.

These units find applications in industrial control systems, test equipment, thermal sensors, and general infrared instrumentation.

SPECIFICATIONS

| Detector Position | TOP | BOTTOM |
|----------------------------|---------------------------|---------------------------|
| Detector Type | UV Si Photodiode | InGaAs Photodiode |
| Active Diameter (mm) | 5 | 3 |
| Operating Wavelength (µm) | 0.2 – 1.0 | 1.0 – 1.7 |
| Shunt Resistance (Ω) | 50 M | 5 M |
| Shunt Capacitance (pF) | 1000 typ | 1000 typ |
| Responsivity (A/W) | 0.5 @ 0.9 µm | 0.6 @ 1.3 µm |
| NEP (W/Hz ^{1/2}) | < 3.0 x 10 ⁻¹⁴ | < 1.5 x 10 ⁻¹³ |