

2 - COLOR TE - COOLED PHOTODIODE

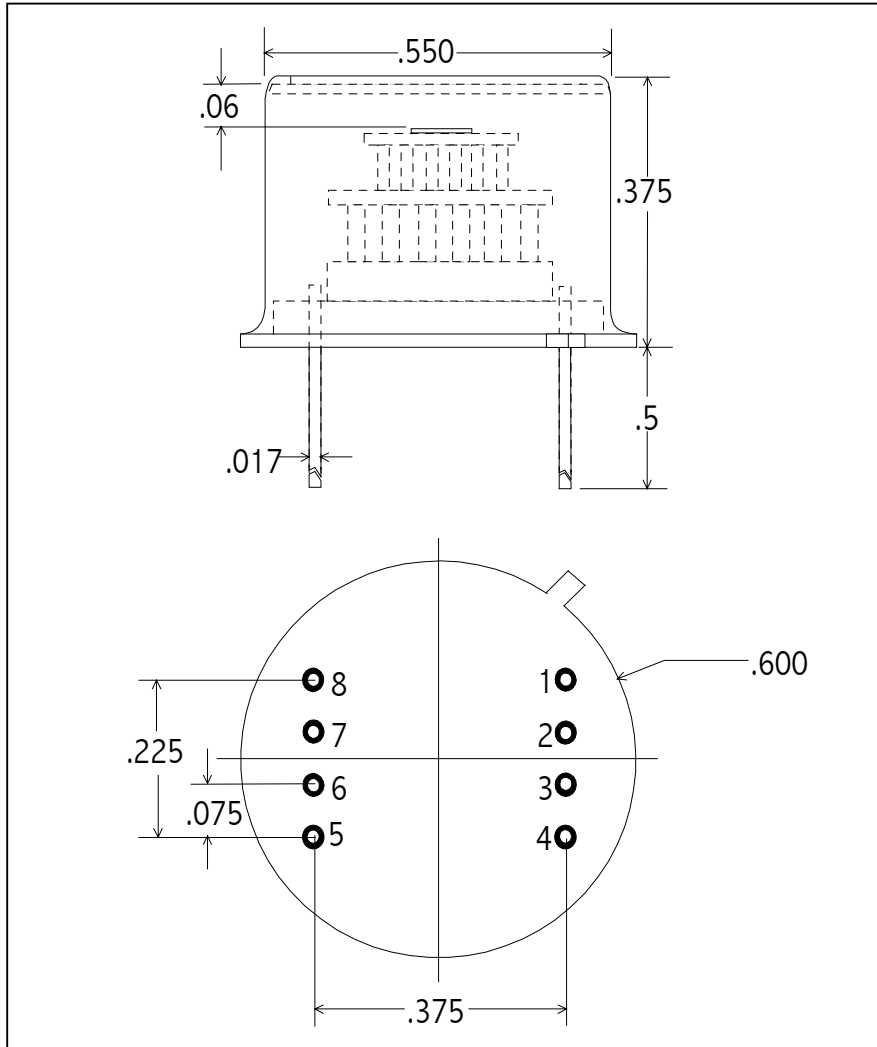

Part No:

UVS/IGA2.2-025/010-TE2

PIN OUT

- 1 = COOLER (-)**
- 2 = THERMISTOR**
- 3 = THERMISTOR**
- 4 = COOLER (+)**
- 5 = BOTTOM CATHODE**
- 6 = BOTTOM ANODE**
- 7 = TOP ANODE**
- 8 = TOP CATHODE**

Note: Dimensions in inches

Operating Note

The TE cooled photodiode series consists of high performance photodiodes mounted on a thermoelectric cooler, all housed in a TO-8 package. A thermistor is mounted to the TEC's cold plate to provide a precise, reliable temperature monitor. Before operation VERIFY ELECTRICAL WIRING, else catastrophic damage may be sustained by the unit. Electrical power consumption can exceed 2.5 Watts (2V / 1.25A); therefore, this package must be

suitably heat sunk. Thermal grease with secure clamping is recommended for power dissipation. Temperature levels below -45°C are possible with an optimized mechanical assembly.

SPECIFICATIONS

Detector Type	Top: 2.5mm dia UV Silicon	Bottom: 1mm dia ex-InGaAs
Operating Temperature - ($^{\circ}\text{C}$)	22 / -30	22 / -30
Shunt Resistance - (Ω), min	100M / $> 10^9$	3k / 100k
Shunt Capacitance - (pF), typ	300 / 290	300 / 290
Responsivity @ pk μm (A/W)	0.5	0.6 min (inc Si tran)
Operating Wavelength - (nm)	200 - 1000	1200 - 2600 / 1200 - 2400
Thermistor Resistance - ($\text{k}\Omega$) typ	1.8 / 40	1.8 / 40
Cooler Current - (A) typ	0.00	0.60
Maximum Cooler Current - (A)	1.25	