

## H - SERIES PYROELECTRIC / RECEIVER

**Application Note** This unit is a high performance pyroelectric/receiver operated at ambient temperature with a dual gain voltage amplifier. The LT Unit is an AC coupled dual gain detector system requiring a modulated input signal for operation.

**Part Number:**  
**LT - 050 - H**

**DB-9 PIN OUT**

1	NO CONNECT	6	+V
2	NO CONNECT	7	-V
3	NO CONNECT	8	GND
4	NO CONNECT	9	CASE GND
5	NO CONNECT		

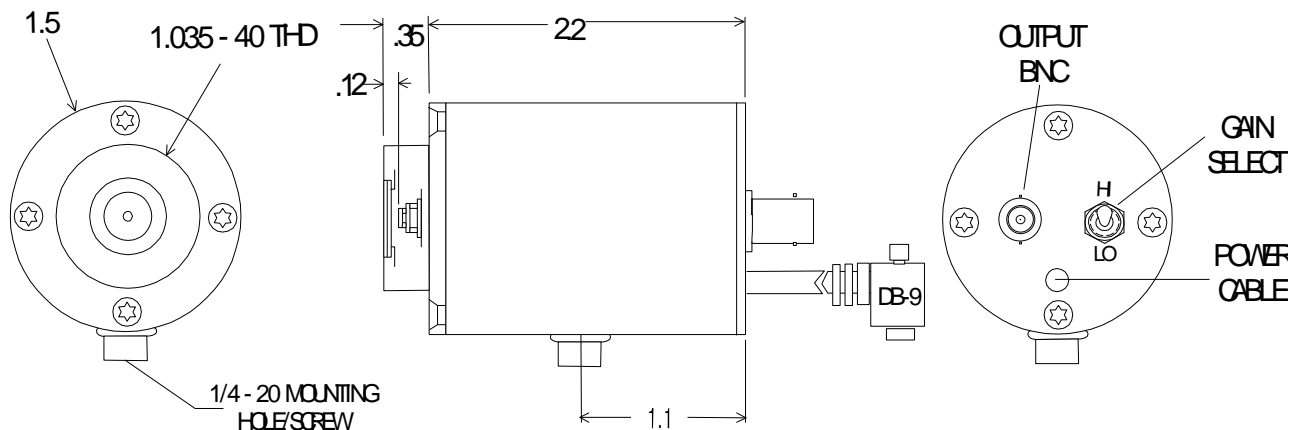

### SPECIFICATIONS

<b>Detector Type</b>	<b>5 mm dia Lithium Tantalate</b>
<b>Operating Temperature- °C</b>	<b>22</b>
<b>Operating Wavelength- μm</b>	<b>2 - 16+ (ARGE Window )</b>
<b>Responsivity- V/W</b>	<b>10<sup>4</sup> / 10<sup>3</sup></b>
<b>Noise- V/Hz<sup>1/2</sup> @ 10.</b>	<b>50. x 10<sup>-6</sup> / 10<sup>-7</sup></b>
<b>NEP- W/Hz<sup>1/2</sup> @ 10 Hz</b>	<b>&lt; 5.0 x 10<sup>-9</sup></b>
<b>Bandwidth (-3dB)- Hz</b>	<b>1 - 30</b>
<b>Power Requirements</b>	<b>+/- 9 VDC to +/- 15 VDC</b>
<b>Connections</b>	<b>BNC signal output. Shielded power cable terminated with a DB-9 connector directly couples the unit with the PS -1 Low Noise Power Supply.</b>

*RoHS Compliant*